

**Crosses to ANSI B16.11**

**Threaded to ANSI B2.1**

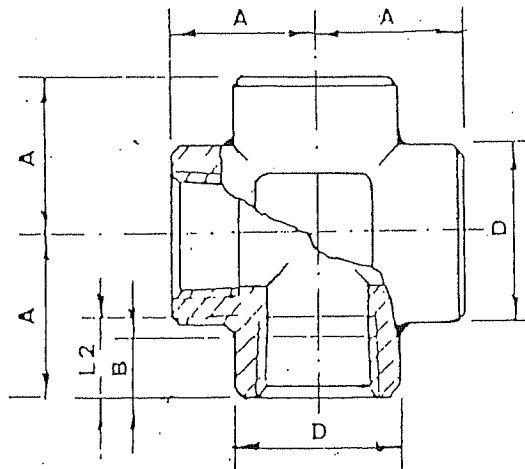

3000 lbs				6000 lbs			
ND	A	D	Weight Kilos/Each	ND	A	D	Weight Kilos/Each
1/8"	21	22	0.230	1/8"	25	25	0.320
1/4"	25	25	0.285	1/4"	29	33	0.590
3/8"	29	33	0.530	3/8"	33	38	0.830
1/2"	33	38	0.760	1/2"	38	46	1.350
3/4"	38	46	1.140	3/4"	44	56	2.040
1"	44	56	1.760	1"	51	62	2.700
1 1/4"	51	62	2.100	1 1/4"	60	75	4.500
1 1/2"	60	75	3.850	1 1/2"	64	84	5.800
2"	64	84	4.240	2"	83	102	11.600
2 1/2"	83	102	9.300	2 1/2"	95	121	18.000
3"	95	121	13.000	3"	106	146	28.500
4"	114	152	25.000	4"	114	152	27.000

\* on request

**COMMON DIMENSIONS TO ALL CLASSES**

SIZE	B (1) min.	L2 min.
1/8"	6.5	6.5
1/4"	8.0	10.0
3/8"	9.0	10.5
1/2"	11.0	13.5
3/4"	12.5	14.0
1"	14.5	17.5
1 1/4"	17.0	18.0
1 1/2"	18.0	18.5
2"	19.0	19.0
2 1/2"	23.5	29.0
3"	26.0	30.5
4"	27.5	33.0

Dimensions are in mm.

(1) Dimension B is minimum length of perfect thread. The length of useful thread (B plus threads with fully formed roots and flat crests) shall not be less than L2 (effective length of external thread) required by American National Standard for Pipe Threads (ANSI B2.1)

Crosses to ANSI B 16.11

Socket Weld to ANSI B 16.11

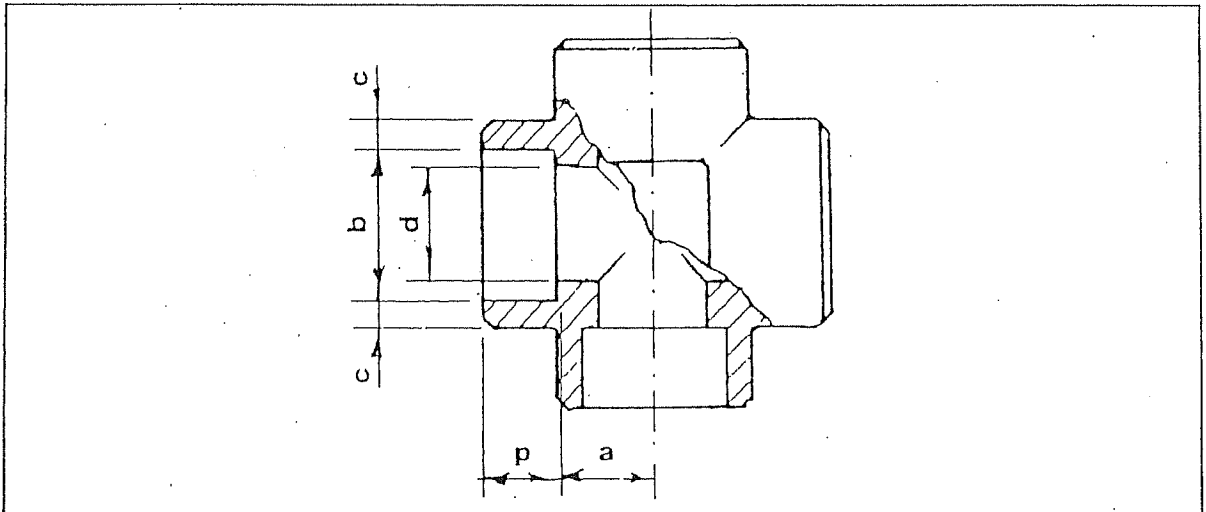

ND	a		b (1)		c	d		p	Weight Kilos/Each
	max.	min.	max.	min.	min.	max.	min.	min.	
3000 lbs									
1/8"	12	10	10.90	10.65	3.20	7.6	6.1	10	0.205
1/4"	12	10	14.30	14.10	3.30	10.0	8.5	10	0.205
3/8"	15	12	17.80	17.55	3.50	13.3	11.8	10	0.235
1/2"	17	14	21.95	21.70	4.10	16.6	15.0	10	0.450
3/4"	21	18	27.30	27.05	4.25	21.7	20.2	13	0.610
1"	24	20	34.05	33.80	5.00	27.4	25.9	13	0.900
1 1/4"	29	25	42.80	42.55	5.30	35.8	34.3	13	1.270
1 1/2"	34	30	48.90	48.65	5.55	41.7	40.1	13	1.700
2"	40	36	61.35	61.10	6.05	53.5	51.7	16	2.450
2 1/2"	44	39	74.20	73.80	7.65	64.2	61.2	16	4.900
3"	60	55	90.15	89.80	8.30	79.5	76.4	16	8.150
4"	69	64	115.80	115.45	9.35	103.8	100.7	19	13.000
6000 lbs									
1/8"	12	10	10.90	10.65	3.45	4.8	3.2	10	0.230
1/4"	17	13	14.35	14.10	4.00	7.1	5.6	10	0.285
3/8"	17	14	17.80	17.55	4.35	9.9	8.4	10	0.570
1/2"	21	18	21.95	21.70	5.20	12.5	11.0	10	0.650
3/4"	24	21	27.30	27.05	6.05	16.3	14.8	13	1.060
1"	29	25	34.05	33.80	6.95	21.5	19.9	13	1.550
1 1/4"	34	30	42.80	42.55	6.95	30.2	28.7	13	2.200
1 1/2"	40	36	48.90	48.65	7.80	34.7	33.2	13	2.420
2"	43	39	61.35	61.10	9.50	43.6	42.1	16	5.050
2 1/2"	-	-	74.20	73.80	10.40	-	-	16	11.000
3"	-	-	90.15	89.80	12.20	-	-	16	16.000

Dimension are in mm

(1) Upper and lower for each size are the respective maximum and minimum dimensions.