

45° Elbows to ANSI B16.11

Threaded to ANSI B2.1

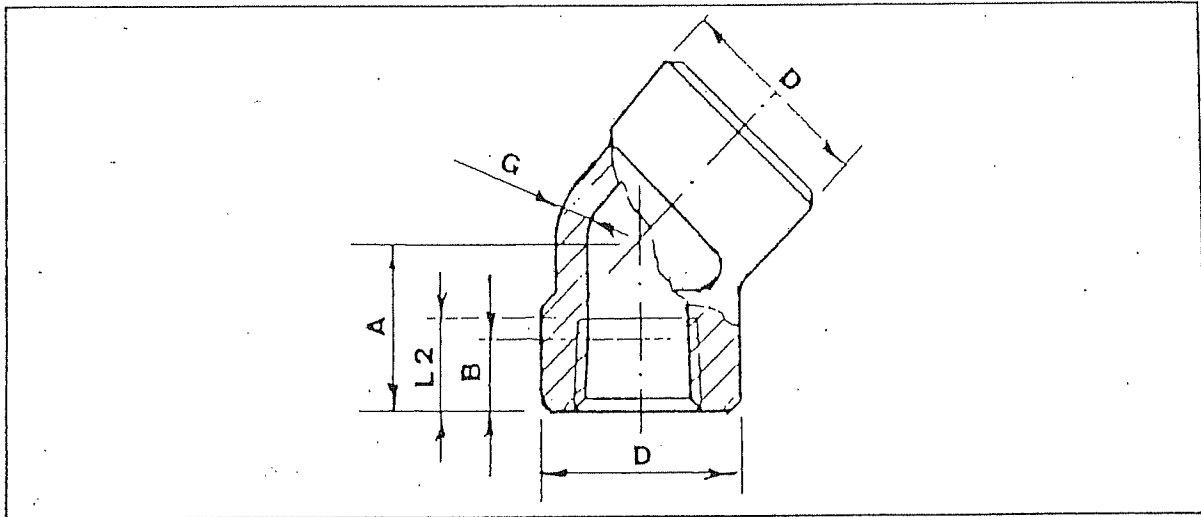

3000 lbs				
ND	A	D	G min.	Weight Kilos/Each
1/8"	17	22	3.0	0.120
1/4"	19	25	3.5	0.150
3/8"	22	33	3.5	0.280
1/2"	25	38	4.0	0.380
3/4"	29	46	4.5	0.560
1"	33	56	5.0	0.910
1 1/4"	35	62	5.5	1.150
1 1/2"	43	75	5.5	1.850
2"	45	84	7.0	2.100
2 1/2"	52	102	7.5	4.850
3"	64	121	9.0	6.650
4"	79	152	11.0	12.500

6000 lbs				
ND	A	D	G min.	Weight Kilos/Each
1/8"	19	25	6.5	0.165
1/4"	22	33	6.5	0.310
3/8"	25	38	7.0	0.420
1/2"	29	46	8.0	0.650
3/4"	33	56	8.5	1.050
1"	35	62	10.0	1.410
1 1/4"	43	75	10.5	2.150
1 1/2"	44	84	11.0	2.750
2"	52	102	12.0	6.150
2 1/2"*	64	121	15.5	8.600
3"*	79	146	16.5	15.000
4"*	79	152	18.5	23.000

* on request
COMMON DIMENSION TO ALL CLASSES

DN SIZE	B (1) min.	L2 min.
1/8"	6.5	6.5
1/4"	8.0	10.0
3/8"	9.0	10.5
1/2"	11.0	13.5
3/4"	12.5	14.0
1"	14.5	17.5
1 1/4"	17.0	18.0
1 1/2"	18.0	18.5
2"	19.0	19.0
2 1/2"	23.5	29.0
3"	26.0	30.5
4"	27.5	33.0

Dimensions are in mm.
(1) Dimension B is minimum length of perfect thread. The length of useful thread (B plus threads with fully formed roots and flat crests) shall not be less than L2 (effective length of external thread) required by American National Standard for Pipe Threads (ANSI B2.1)

45° Elbows to ANSI B 16.11

Socket Weld to ANSI B 16.11

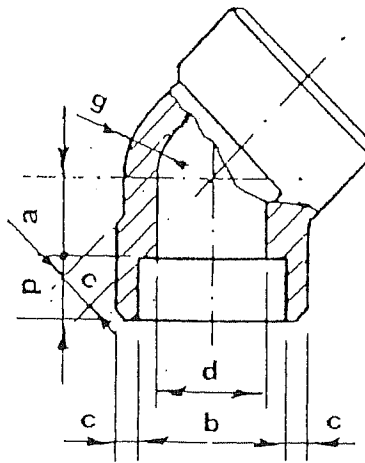

ND	g		a		b (2)		c (1)		d		p	Weight Kilos/Each
	min.	max.	ANSI min.	max.	max.	min.	ave	min.	max.	min.	min.	
3000 lbs												
1/8"	2.40	9	7	10.90	10.65	3.20	3.20	7.6	6.1	10		0.100
1/4"	3.00	9	7	14.35	14.10	3.80	3.30	10.0	8.5	10		0.100
3/8"	3.20	9	6	17.80	17.55	4.00	3.50	13.3	11.8	10		0.120
1/2"	3.75	13	10	21.96	21.70	4.65	4.10	16.6	15.0	10		0.240
3/4"	3.90	14	11	27.30	27.05	4.90	4.25	21.7	20.2	13		0.330
1"	4.55	16	12	34.05	33.80	5.70	5.00	27.4	25.9	13		0.460
1 1/4"	4.85	19	15	42.80	42.55	6.05	5.30	35.8	34.3	13		0.660
1 1/2"	5.10	23	19	48.90	48.65	6.35	5.55	41.7	40.1	13		0.890
2"	5.55	27	23	61.35	61.10	6.95	6.05	53.5	51.7	16		1.250
2 1/2"	7.00	31	27	74.20	73.80	8.75	7.65	64.2	61.2	16		2.650
3"	7.60	34	29	90.15	89.80	9.50	8.30	79.5	76.4	16		4.000
4"	8.55	44	39	115.80	115.45	10.70	9.35	103.8	100.7	19		8.000
6000 lbs												
1/8"	3.15	9	7	10.90	10.65	3.95	3.45	4.8	3.2	10		0.120
1/4"	3.70	9	7	14.35	14.10	4.60	4.00	7.1	5.6	10		0.150
3/8"	4.00	13	10	17.80	17.55	5.05	4.35	9.9	8.4	10		0.290
1/2"	4.80	14	11	21.95	21.70	5.95	5.20	12.5	11.0	10		0.320
3/4"	5.55	16	13	27.30	27.05	6.95	6.10	16.3	14.8	13		0.540
1"	6.35	19	15	34.05	33.80	7.90	7.00	21.5	19.9	13		0.770
1 1/4"	6.35	23	19	42.80	42.55	7.90	7.00	30.2	28.7	13		1.100
1 1/2"	7.15	27	23	48.90	48.65	8.90	7.80	34.7	33.2	13		1.700
2"	8.75	31	27	61.35	61.10	10.90	9.50	43.6	42.1	16		2.700
2 1/2"												
3												

Dimensions are in mm.

(1) Average of Socket Wall Thickness around periphery shall be not less than listed values. The minimum values are permitted in localized areas.

(2) Upper and lower values for each size are the respective maximum and minimum dimensions.