

Reducing Couplings

Threaded to ANSI B 2.1

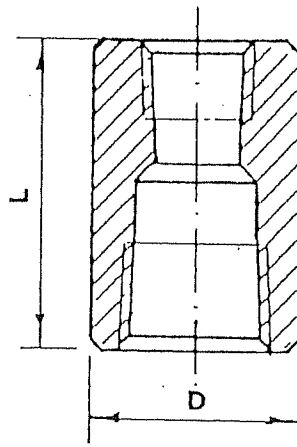

SIZE	3000 lbs		6000 lbs		Weight Kilos/Each	
	D	L	D	L	3000	6000
3/8 x 1/4	22	according to manufacturers option	32	according to manufacturers option	0.071	0.197
1/2 x 3/8	29		38		0.152	0.337
1/2 x 1/4	29		38		0.188	0.373
3/4 x 1/2	35		44		0.235	0.472
3/4 x 1/4	35		44		0.285	0.522
1 x 3/4	44		57		0.498	0.971
1 x 1/2	44		57		0.540	1.110
1 x 1/4	44		57		0.575	1.150
1 1/4 x 1	57		64		0.832	1.150
1 1/2 x 1	64		76		1.280	2.135
1 1/2 x 3/4	64		76		1.370	2.225
1 1/2 x 1/2	64		76		1.485	2.340
2 x 1 1/2	76		92		1.610	3.142
2 x 1	76		92		1.925	3.455
2 1/2 x 2	92		108		2.765	4.315
3 x 2	108		127		5.080	7.535
4 x 3	140	159	8.229	12.700		
4 x 2	140	159	9.620	14.100		

Dimensions in mm

Reducing Couplings

Socket Weld to ANSI B16.11

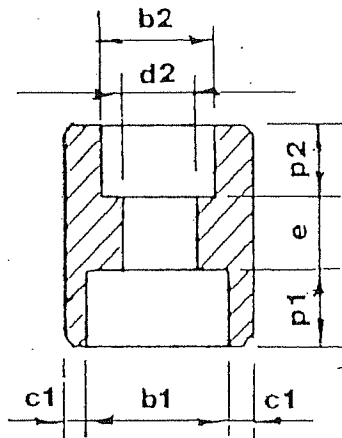

ND	COMMON SIZES				REDUCTIONS			Weight Kilos/Each
	b1 min.	c1 min.	E average	p1 min.	b2 min.	d2 average	p2 min.	
3000 lbs								
3/8 x 1/4	17.55	3.50	6.00	10	14.10	9.25	10	0.095
1/2 x 3/8	21.70	4.10	9.50	10	17.55	12.55	10	0.175
1/2 x 1/4	21.70	4.10	9.50	10	14.10	9.25	10	0.195
3/4 x 1/2	27.05	4.30	9.50	13	21.70	15.80	10	0.250
3/4 x 1/4	27.05	4.30	9.50	13	14.10	9.25	10	0.220
1 x 3/4	33.80	5.00	13.00	13	27.05	20.95	13	0.430
1 x 1/2	33.80	5.00	13.00	13	21.70	15.80	10	0.450
1 x 1/4	33.80	5.00	13.00	13	14.10	9.25	10	0.480
1 1/4 x 1	42.55	5.30	13.00	13	33.80	26.65	13	0.595
1 1/2 x 1	48.65	5.60	13.00	13	33.80	26.65	13	0.600
1 1/2 x 3/4	48.65	5.60	13.00	13	27.05	20.95	13	0.595
1 1/2 x 1/2	48.65	5.60	13.00	13	21.70	15.80	10	0.570
2 x 1 1/2	61.10	6.10	19.00	16	48.65	40.90	13	1.270
2 x 1"	61.10	6.10	19.00	16	33.80	26.65	13	1.350
6000 lbs								
1/4 x 1/8	14.10	4.00	6.50	10	10.65	4.00	10	0.080
3/8 x 1/4	17.55	4.35	6.00	10	14.10	6.35	10	0.120
1/2 x 3/8	21.70	5.20	9.50	10	17.55	9.15	10	0.220
3/4 x 1/2	27.05	6.10	9.50	13	21.70	11.75	10	0.340
1 x 3/4	33.80	7.00	13.00	13	27.05	15.55	13	0.570
1 1/4 x 1	42.55	7.00	13.00	13	33.80	20.70	13	0.770
1 1/2 x 1 1/4	48.55	7.80	13.00	13	42.55	29.45	13	1.000
2 x 1 1/2	61.10	9.50	19.00	16	48.65	33.95	13	2.120
2 1/2 x 2	73.80	10.40	19.00	16	61.10	42.85	16	2.900
3 x 2 1/2	89.80	12.20	19.00	16	73.80	54.00	16	4.000
Dimensions in mm								