

Tees to ANSI B16.11

Threaded to ANSI B2.1

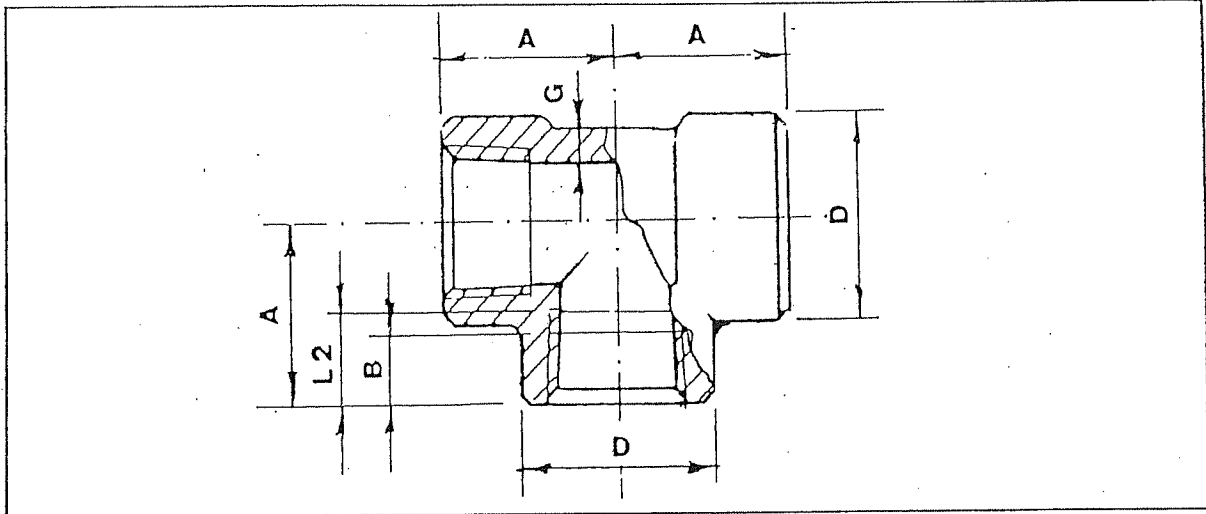

3000 lbs				
ND	A	D	G min.	Weight Kilos/Each
1/8"	21	22	3.0	0.180
1/4"	25	25	3.5	0.230
3/8"	29	33	3.5	0.420
1/2"	33	38	4.0	0.600
3/4"	38	46	4.5	0.910
1"	44	56	5.0	1.400
1 1/4"	51	62	5.5	1.690
1 1/2"	60	75	5.5	3.050
2"	64	84	7.0	3.400
2 1/2"	83	102	7.5	7.400
3"	95	121	9.0	10.400
4"	114	152	11.0	20.000

6000 lbs				
ND	A	D	G min.	Weight Kilos/Each
1/8"	25	25	6.5	0.255
1/4"	29	33	6.5	0.470
3/8"	33	38	7.0	0.665
1/2"	38	46	8.0	1.070
3/4"	44	56	8.5	1.625
1"	51	62	10.0	2.150
1 1/4"	60	75	10.5	3.600
1 1/2"	64	84	11.0	4.600
2"	83	102	12.0	9.250
2 1/2"*	95	121	15.5	14.500
3"*	106	146	16.5	23.000
4"*	114	152	18.5	21.500

* on request

COMMON DIMENSIONS TO ALL CLASSES

SIZE	B (1) min.	L2 min.
1/8"	6.5	6.5
1/4"	8.0	10.0
3/8"	9.0	10.5
1/2"	11.0	13.5
3/4"	12.5	14.0
1"	14.5	17.5
1 1/4"	17.0	18.0
1 1/2"	18.0	18.5
2"	19.0	19.0
2 1/2"	23.5	29.0
3"	26.0	30.5
4"	27.5	33.0

Dimensions are in mm.

(1) Dimension B is minimum length of perfect thread. The length of useful thread (B plus threads with fully formed roots and flat crests) shall not be less than L2 (effective length of external thread) required by American National Standard for Pipe Threads (ANSI B2.1)

Tees to ANSI B 16.11

Socket Weld to ANSI B 16.11

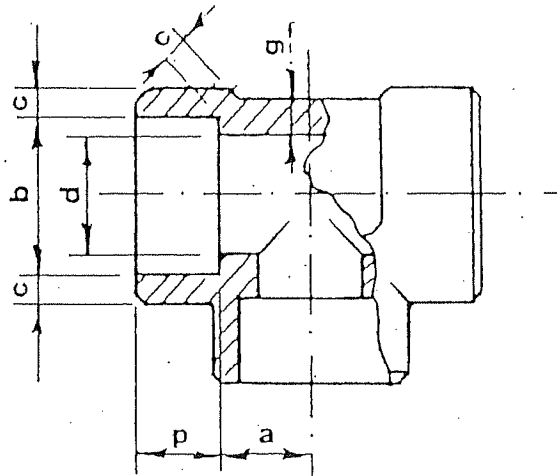

ND	g	a		b (2)		c (1)		d		p	Weight Kilos/Each
	min.	ANSI max.	min.	max.	min.	min.	max.	min.	min.		
3000 lbs											
1/8"	2.40	12	10	10.90	10.65	3.20	7.6	6.1	10		0.165
1/4"	3.00	12	10	14.35	14.10	3.30	10.0	8.5	10		0.165
3/8"	3.20	15	12	17.80	17.55	3.50	13.3	11.8	10		0.190
1/2"	3.75	17	14	21.95	21.70	4.10	16.6	15.0	10		0.360
3/4"	3.90	21	18	27.30	27.05	4.25	21.7	20.2	13		0.490
1"	4.55	24	20	34.05	33.80	5.00	27.4	25.9	13		0.715
1 1/4"	4.85	29	25	42.80	42.55	5.30	35.8	34.3	13		1.010
1 1/2"	5.10	34	30	48.90	48.65	5.55	41.7	40.1	13		1.365
2"	5.55	40	36	61.35	61.10	6.05	53.5	51.7	16		1.950
2 1/2"	7.00	44	39	74.20	73.80	7.65	64.2	61.2	16		3.900
3"	7.60	60	55	90.15	89.80	8.30	79.5	76.4	16		6.500
4"	8.55	69	64	115.80	115.45	9.35	103.8	100.7	19		10.400
6000 lbs											
1/8"	3.15	12	10	10.90	10.65	3.45	4.8	3.2	10		0.180
1/4"	3.70	17	13	14.35	14.10	4.00	7.1	5.6	10		0.230
3/8"	4.00	17	14	17.80	17.55	4.35	9.9	8.4	10		0.450
1/2"	4.80	21	18	21.95	21.70	5.20	12.5	11.0	10		0.520
3/4"	5.55	24	21	27.30	27.05	6.05	16.3	14.8	13		0.850
1"	6.35	29	25	34.05	33.80	6.95	21.5	19.9	13		1.250
1 1/4"	6.35	34	30	42.80	42.55	6.95	30.2	28.7	13		1.750
1 1/2"	7.15	40	36	48.90	48.65	7.80	34.7	33.2	13		2.750
2"	8.75	43	39	61.35	61.10	9.50	43.6	42.1	16		4.000
2 1/2"	-	-	-	74.20	73.80	10.40	-	-	16		8.700
3"	-	-	-	90.15	89.80	12.20	-	-	16		13.000

Dimensions are in mm

(1) Average of Socket Wall Thickness around periphery shall be not less than listed values. The minimum values are permitted in localized areas.

(2) Upper and lower values for each size are the respective maximum and minimum dimensions.