

Threaded Flanges

NP 10 and 16

DIN 2566

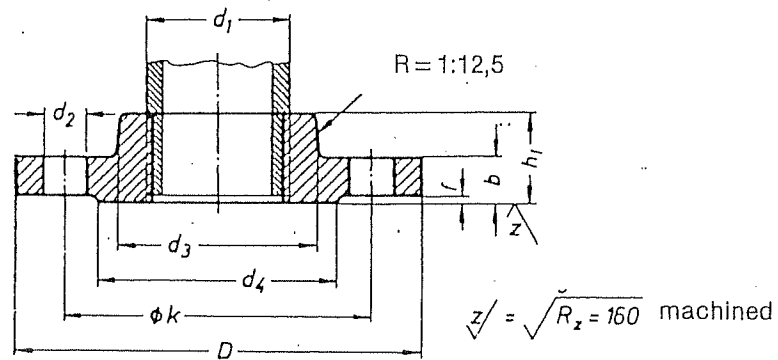

ND	Whitworth Gas thread DIN 2999 \emptyset	d_1	D	b	k	h	d_3	d_4	f	Nr. of holes	Bolt diam.	d_2	Weight kg
6	R 1/8"	10,2	75,	12	50	18	20	32	2	4	M10	11	0,326
8	R 1/4"	13,5	80,	12	55	18	25	38	2	4	M10	11	0,380
10	R 3/8"	17,2	90	14	60	20	30	40	2	4	M12	14	0,544
15	R 1/2"	21,3	95	14	65	20	35	45	2	4	M12	14	0,613
20	R 3/4"	26,9	105	16	75	24	45	58	2	4	M12	14	0,910
25	R 1"	33,7	115	16	85	24	52	68	2	4	M12	14	1,10
32	R 1 1/4"	42,4	140	16	100	26	60	78	2	4	M16	18	1,60
40	R 1 1/2"	48,3	150	16	110	26	70	88	3	4	M16	18	1,78
50	R 2"	60,3	165	18	125	28	85	102	3	4	M16	18	2,43
65	R 2 1/2"	76,1	185	18	145	32	105	122	3	4	M16	18	3,18
80	R 3"	88,9	200	20	160	34	118	138	3	8	M16	18	4,12
100	R 4"	114,3	220	20	180	38	140	158	3	8	M16	18	4,47